

2.0mm PITCH FPC CONNECTORS

REV./ECN NO.	LOCAS.	DESCRIPTION	DATE	DESIGN
A		NEW DRAWING	22.12.01	Jemply

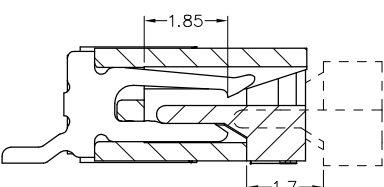
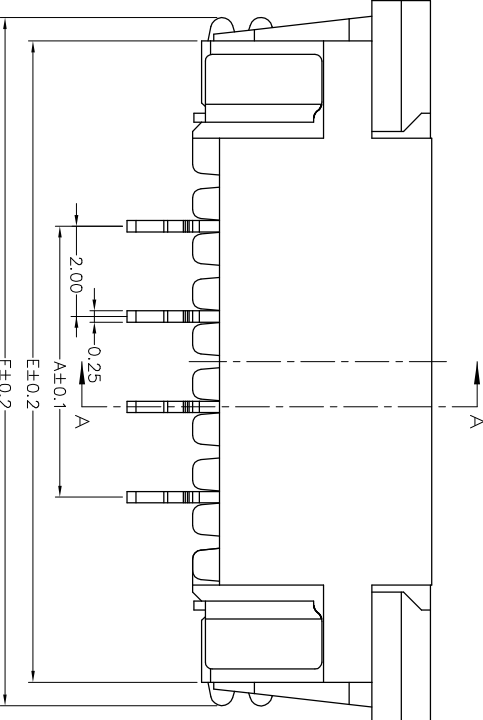
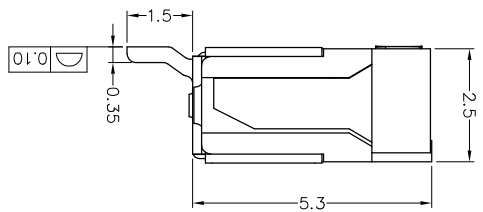
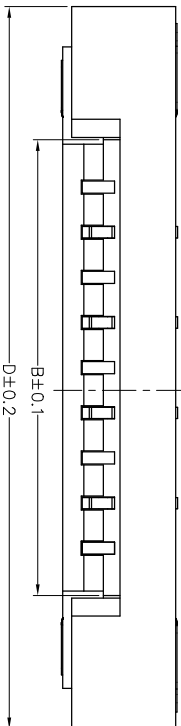
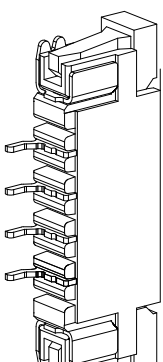

PTN	DIM.A	DIM.B	DIM.C	DIM.D	DIM.E	DIM.F
4	6.00	10.10	10.00	16.00	14.20	15.30
5	8.00	12.10	12.00	18.00	16.20	17.30
6	10.00	14.10	14.00	20.00	18.20	19.30
7	12.00	16.10	16.00	22.00	20.20	21.30
8	14.00	18.10	18.00	24.00	22.20	23.30
9	16.00	20.10	20.00	26.00	24.20	25.30
10	18.00	22.10	22.00	28.00	26.20	27.30
11	20.00	24.10	24.00	30.00	28.20	29.30
12	22.00	26.10	26.00	32.00	30.20	31.30
13	24.00	28.10	28.00	34.00	32.20	33.30
14	26.00	30.10	30.00	36.00	34.20	35.30
15	28.00	32.10	32.00	38.00	36.20	37.30
16	30.00	34.10	34.00	40.00	38.20	39.30
17	32.00	36.10	36.00	42.00	40.20	41.30

SECTION A—A

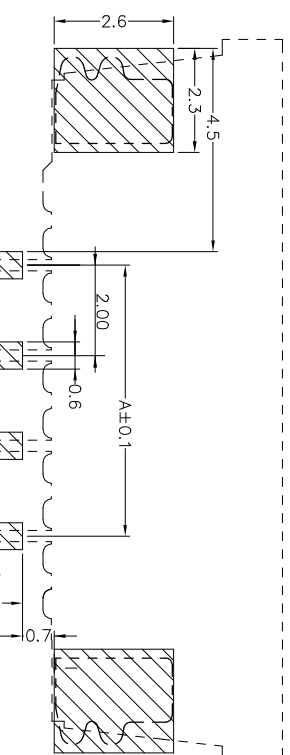

PC BOARD LAYOUT

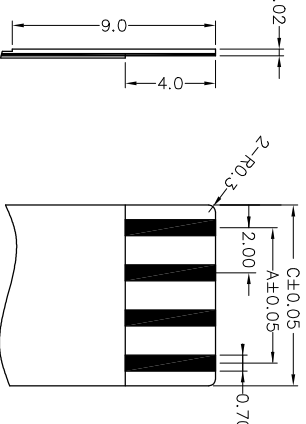

PROPER CABLE (SCALE 2:1)

- 技术要求 (Technical Index):
1. 材质与表面处理 (Material And Finish):
 底座 (Housing) : LCP UL94V-0 Nature;
 盖子 (Cover) : LCP UL94V-0 Black;
 端子 (Terminal) : Phosphor Copper Sn Plated;
 焊片 (Solder) : Copper Alloy Sn Plated;
 2. 工作温度 (Temperature range): $-25^{\circ}\text{C}\sim+85^{\circ}\text{C}$.
 3. 额定电压 (Rated voltage): 50V, AC/DC.
 4. 额定电流: 0.5A AC/DC.
 5. 接触电阻 (Contact resistance): $\leq 20\text{m}\Omega$.
 6. 绝缘电阻 (Insulation resistance): $\geq 800\text{M}\Omega$.
 7. 耐压 (Withstanding Voltage): 200V AC/minute.

DESIGN:	Jemply		REV. A	SCALE: N/A	UNIT: mm	SHEET: 1/1
CHECK:	Ke Tian		REV. A	SCALE: N/A	UNIT: mm	SHEET: 1/1
APPROVED:	Youquan Xu		REV. A	SCALE: N/A	UNIT: mm	SHEET: 1/1
TITLE:	2.0mm FPC 半包上接H=2.5mm		REV. A	SCALE: N/A	UNIT: mm	SHEET: 1/1
PART NO.	2.0K-F50-PM3-***		REV. A	SCALE: N/A	UNIT: mm	SHEET: 1/1
QWYCON® 深圳市启威源电子有限公司 SHENZHEN QIWHEYUAN ELECTRONIC CO., LTD.			REV. A	SCALE: N/A	UNIT: mm	SHEET: 1/1